

B2B Door Pulls

FEATURES & OPTIONS

Round Ladder Pulls : 1" Dia x 3/4" Leg

Finish :

Brushed Stainless (32D / C15)

Flat Black (L1)

Lengths available: 7-1/16" CTC x 12" Overall

Door Preparation

See routing specification for Flush Pull

Drill 2 holes using 1/2" drill bit at appropriate CTC according to the size of your pull handle.

Door Thickness

Fits 1-3/8" to 1-3/4" standard

Handing

Non-handed Single or Back to Back

Material

Stainless Steel / Steel

Extension from 1-3/8" to 1-3/4"

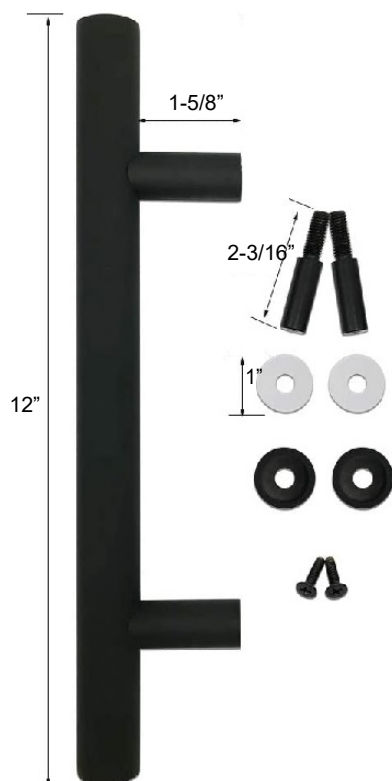
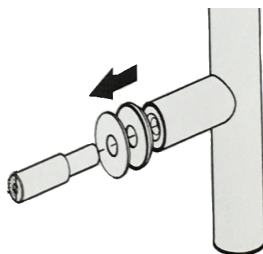

SKU # 045-71282-32D

SKU # 045-71282-L1

Routing Specification

